

Fuel Pump FP 165-E



- ▶ >165 l/h
- ▶ Max. 6 bar
- ▶ 700 g
- ▶ Fuel lines screwed
- ▶ Internal pre-filter on suction side with 300 µm

The FP 165-E is an inline roller cell pump for the installation outside the fuel tank (installation in tank not proven).

It is capable of providing <165 l/h at 6 bar. Bio-fuel and Diesel can be delivered up to E100 (shortens lifetime!).

The FP 165-E is a production type fuel pump, combining good quality at a low price.

Application

Fuel pressure	0.5 up to 6 bar
Delivery rate at 5 bar and 22°C	190 l/h at 4.3 bar
Pressure limiting valve	8 to 10.0 bar rel.
Fuel compatibility	Up to E100 with shorter life-time
Diesel compatibility	Given
Operating temperature range	-40 to 80°C ≤90°C for ≤5 h over 1.000 h lifetime ≤105°C for ≤1 h over 50 h life-time
Storage temperature range	-40 to 60°C
Max. vibration IEC 60068-2-34	10 Hz 19,4 (m/s ²) ² /Hz 300 Hz 0,654 (m/s ²) ² /Hz 1.000 Hz 0,059 (m/s ²) ² /Hz

Technical Specifications

Mechanical Data

Diameter	60 mm
Length	162.6 mm
Weight	700 g

Mounting

Clamping

Electrical Data

Supply voltage	6 to 15 V
Operating voltage	13 V (26 V for 60 s)
Load current at 5 bar and 22°C	<14 A

Characteristic

Color	Silver
Non-return valve	Internal
Overpressure valve	Internal

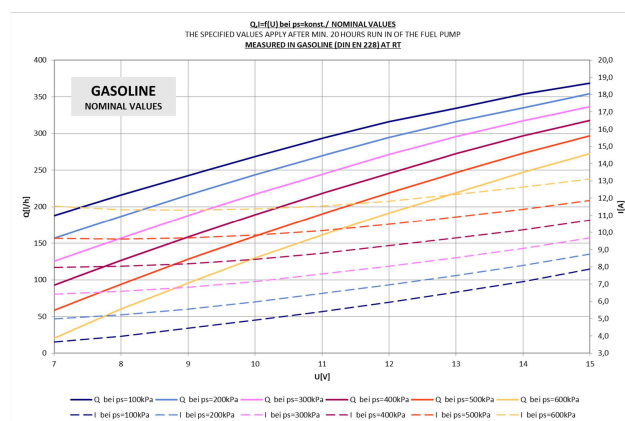

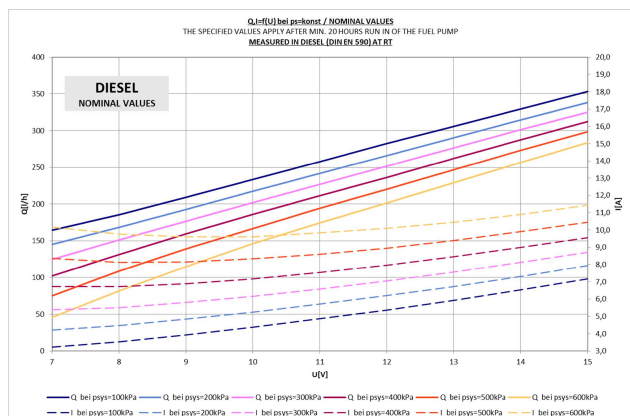

Connectors and Wires

Electrical connector	+M4/-M5
Electrical mating connector	with ring wire M4 and M5
Mechanical connector intake side	M14x1.5
Mechanical connector pressure side	M12x1.5

Installation Notes

Up to E100 with shorter lifetime

For technical reasons the values may vary.

Please use within the specified limit values only.

Please find further application hints in the offer drawing at our homepage.

Legal Restrictions

Due to embargo restrictions, sale of this product in Russia, Belarus, Iran, Syria, Libya, Afghanistan, and North Korea is prohibited.

Ordering Information

Fuel Pump FP 165-E

Order number **F.02U.V03.137-01**

Dimensions

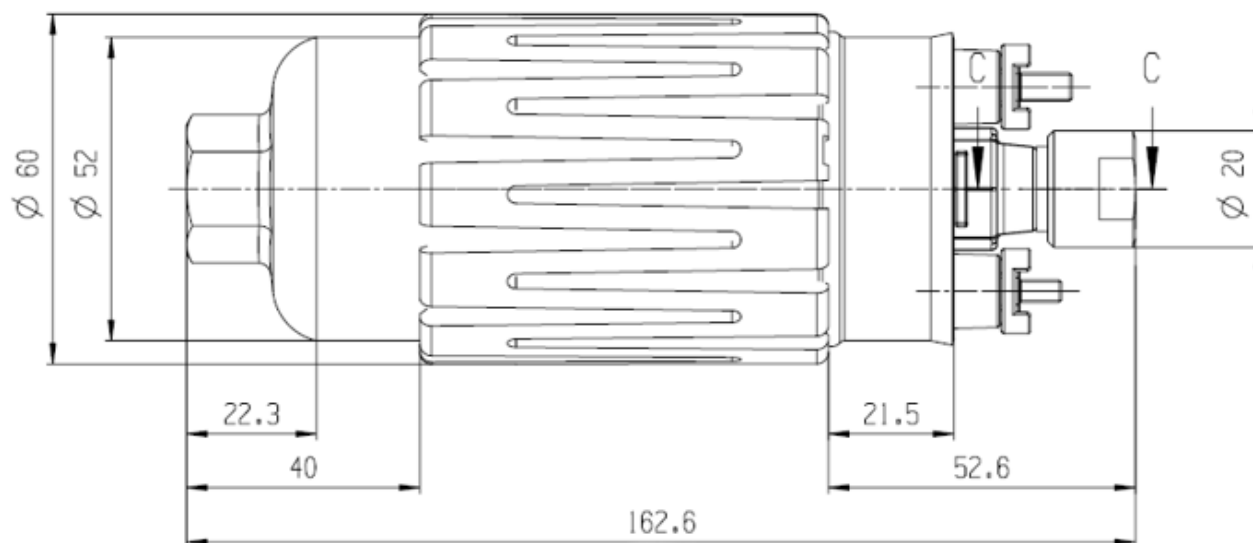

Represented by:

Europe:
Bosch Engineering GmbH
Motorsport
Robert-Bosch-Allee 1
74232 Abstatt
Germany
motorsport@bosch.com
www.bosch-motorsport.de

North America:
Bosch Engineering North America
Motorsport
38000 Hills Tech Drive
Farmington Hills, MI 48331-3417
United States of America
motorsport@bosch.com
www.bosch-motorsport.com

Asia-Pacific:
Bosch Engineering Japan K.K.
Motorsports Department
1-9-32 Nakagawachuo, Tsuzuki-ku
Yokohama-shi
Kanagawa, 224-8601
Japan
motorsport@jp.bosch.com
www.bosch-motorsport.jp

Australia, New Zealand and South Africa:
Robert Bosch Pty. Ltd
Motorsport
1555 Centre Road
Clayton, Victoria, 3168
Australia
motor.sport@au.bosch.com
www.bosch-motorsport.com.au